

We Work & Share Together

Better Value Beyond Growth

MIRETECH

CONTENTS

COMPANY

- History
- Quality Management & Assurance

PRODUCT

I . MIRE Form Tie System

- One Touch Form Tie System p.12
- Inno Form Tie System p.18
- Easy Form Tie System p.24
- Dywidag Form Tie System p.28

II. Gang-Forming Part

- Anchor Accessories p.34
- Setting Accessories p.35

III. Aluminium Form & AL-Forming Part

- Mico Panel p.38
- Aluforms U.S Panel p.40
- Tie p.43
- Pin & Wedge & Clip p.47
- Waler Bracket p.50
- Turnbuckle Bracket p.51
- Tool p.52
- Kicker Anchor p.56
- Column p.60
- Scaffold Bracket p.62
- MISC p.63

IV. Euro-Forming Part

- Tie p.67
- Wedge & Hook p.69

V. Wood-Forming Part

- Dywidag Form Tie System p.75
- Form Tie Bolt System p.76

HISTORY

1999.04

MIRETECH Co., Ltd founded

2003.04

The headquarter was relocated to new building.

2008.01

Seoul Central Office opened

2009.11

Constructed 2nd factory
Bolt manufacturing line

2012.02

Constructed 3rd factory
Wire Drawing line

2013.07

Constructed the 4th factory
Coil Rolling Mill line
Coil Slitting line

2014.11

Constructed the 5th factory
Former line

2016.11

Constructed the 6th factory
Al form manufacturing line

2018.05

Seoul Central Office relocated to Suseo

2018.08

Constructed Aluminum Form Factory in Mungyeong
Al form manufacturing line

1999

Joso Form Tie System

Joso Tie



Mire Washer and Unit



Insert Cone



MIRE WALER SYSTEM

Mire Bar



Multi Bar



Multi Bracket



2004

Al-Flat Tie



2005

One Touch Form Tie System/
AL Form Accessories

One-Touch Borad



Al-One Touch Tie



Fixed One Touch Bolt



Al-Bracket



Al-Round Pin



Al-Wedge Pin



Al-Round Long Pin



2006

Inno Form Tie System

Inno-Board



Al-Inno Tie



Fixed Anchor Bolt



2008

Al Turnbuckle Bracket



2009

Easy Form Tie System

Easy Board



Mire-Washer



Al-Reusable Tie / Tie Sleeve



Gang Form setting accessories
Anchor Fixing Cap



Gang Form Fixing Washer



Gang Form Joint Pin Set



2010

Al-Flat Tie : Design Change



2011

Knar Anchor Bolt



2013

Kicker Nut



Kicker Bolt



2016

AL-FORM



QUALITY

Quality Management & Assurance

Miretech possesses competitive quality and productivity through know-how and technology accumulated over time. Enthusiastic, talented professionals consider customer satisfaction as their top priority and will make a difference and challenge the status quo.

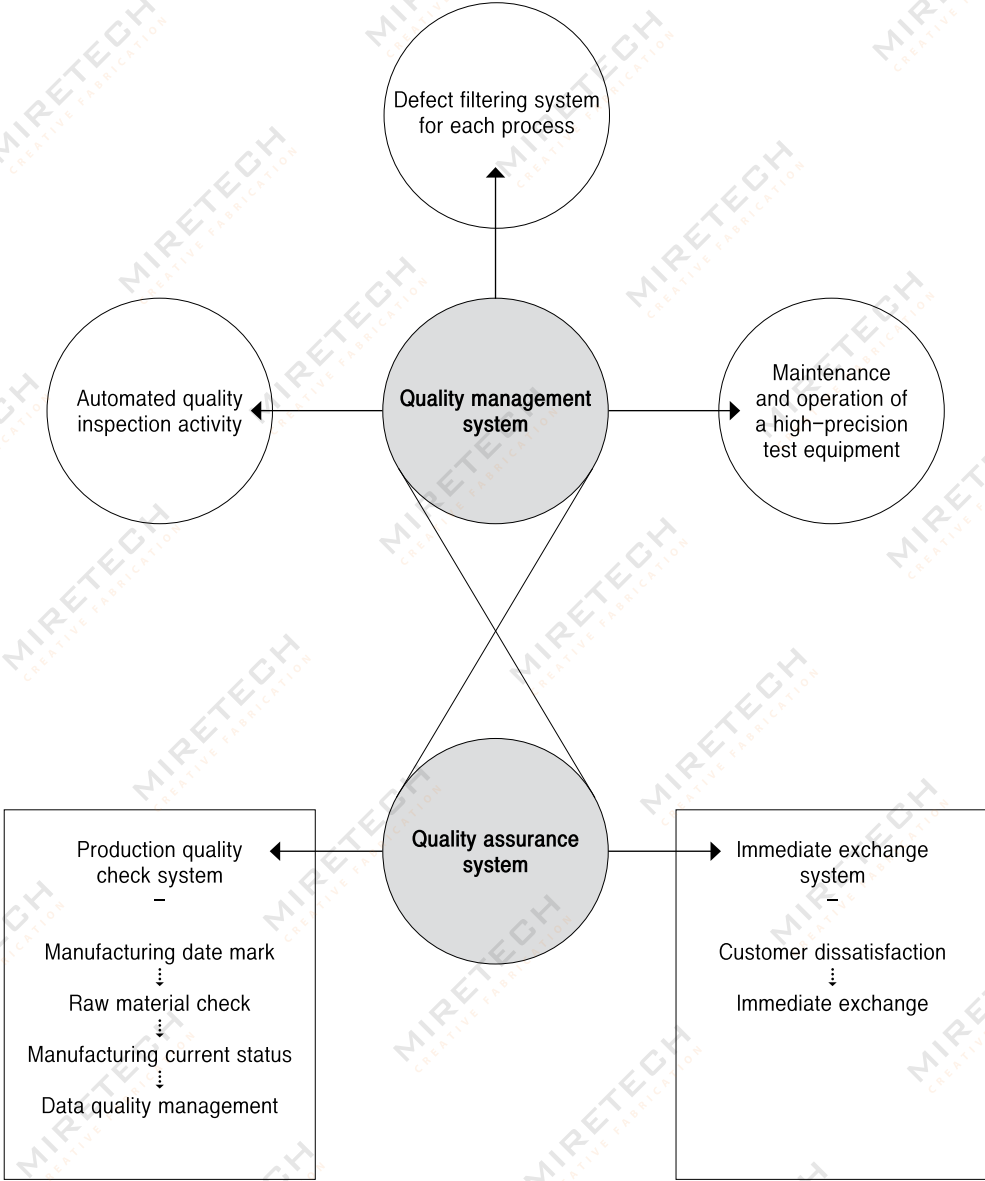

SAFE-TECH

Safe Technology

Tie



Universal Testing Machine

Pin



Micro-Vickers Hardness Tester

Rockwell Hardness Tester



Salt Spray Testing

The image shows a construction site at sunset. The sky is a warm orange-yellow color. In the foreground, the dark silhouette of a building's steel framework is visible, with some windows glowing from interior lights. A large tower crane with a long jib extends from the left side of the frame towards the right. Several vertical rebar structures are visible in the background. The overall scene is industrial and dramatic due to the low light.

MIRE Form Tie System

One Touch Form Tie System

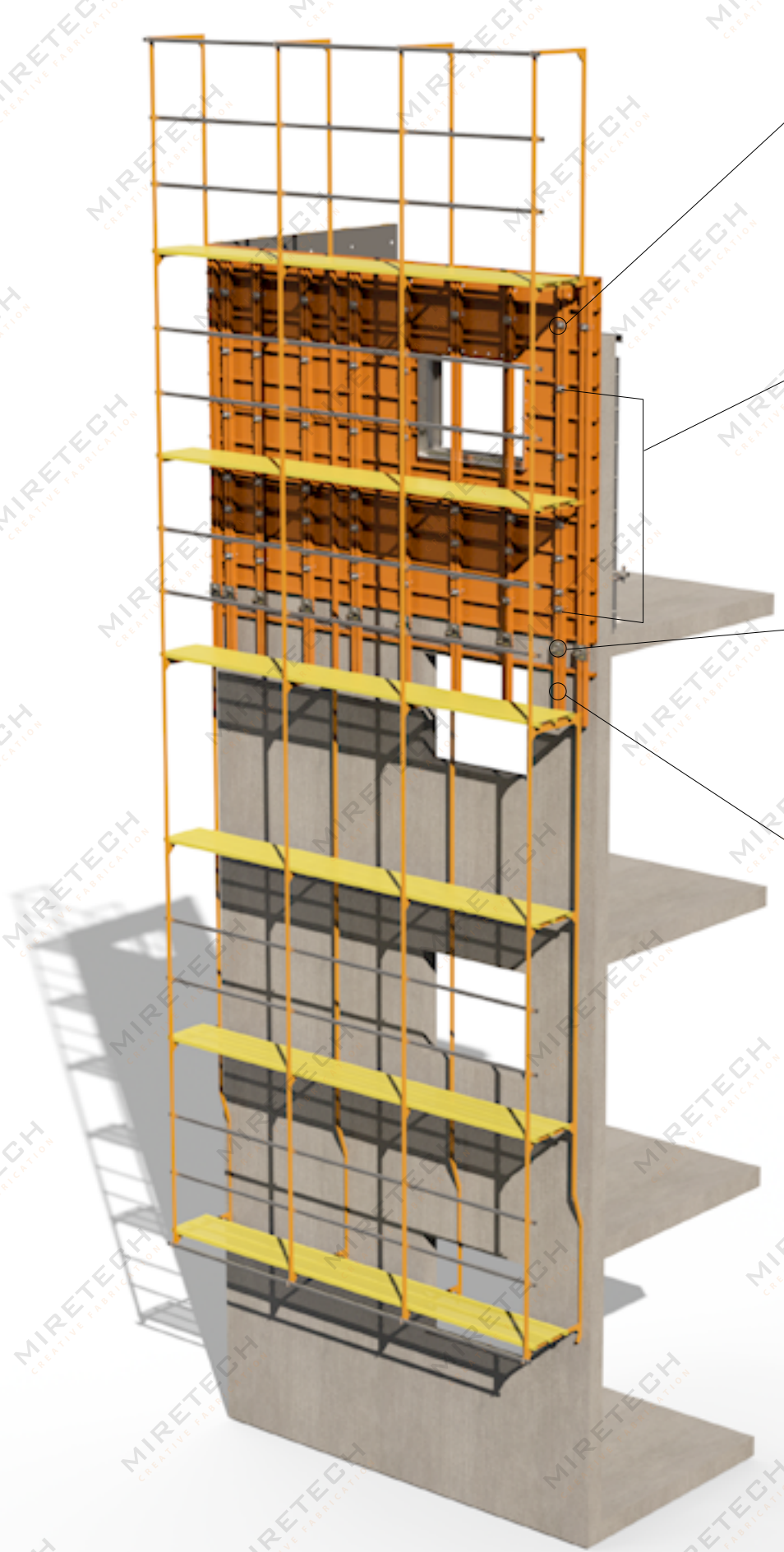

Embedded Anchor [Set]



Embedded Anchor



One Touch Form Tie [Set]



Gang Form Fixing Anchor [Set]

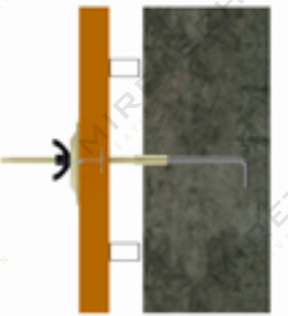
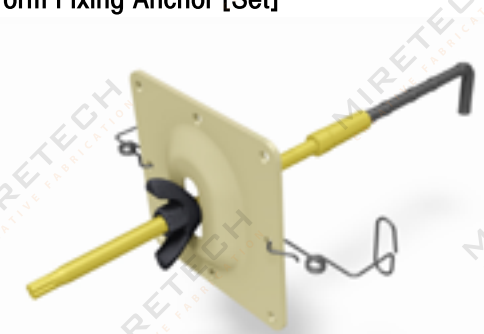

Gang Form Fixing Anchor [Set] [Add]

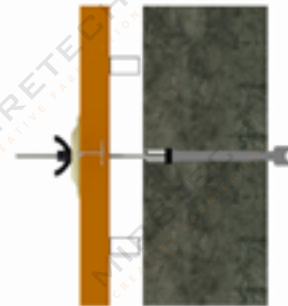
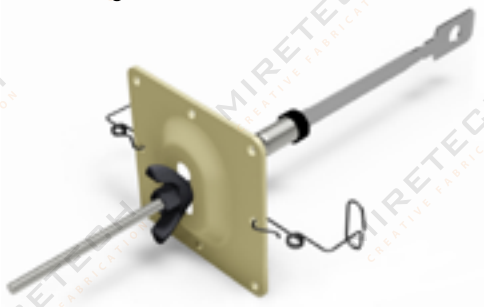

One Touch Form Tie System

One Touch Unit [General]

Tensile Load / 6,000 kgf

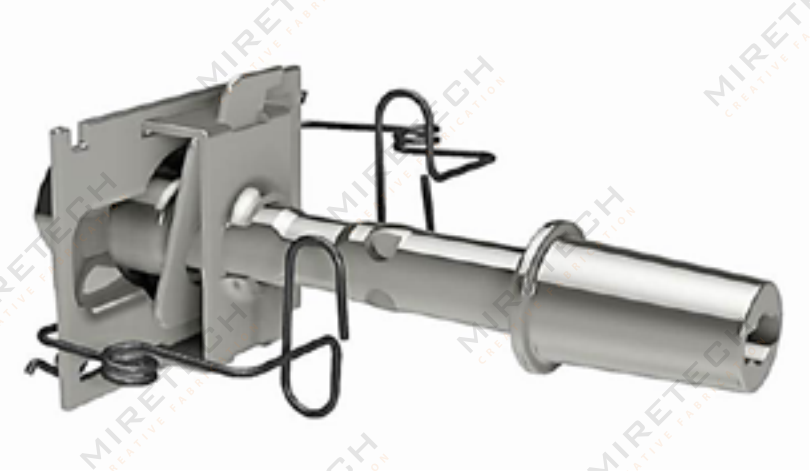

One Touch Unit [Pattern]

Tensile Load / 6,000 kgf



Order Manufacturing/Packaging

AL-One Touch Tie

Tensile Load / 3,000 kgf

Thickness / 2.8t



Euro-One Touch Tie

Tensile Load / 2,900 kgf

Thickness / 2.8t



One Touch Bolt

Tensile Load / 3,000 kgf

Diameter / 12mm



One Touch Fixable Bolt

Tensile Load / 6,100 kgf

Diameter / 12mm

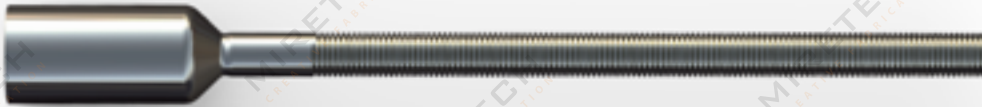

Order Manufacturing/Packaging

One Touch Form Tie System

How To Use?

Unit Setting

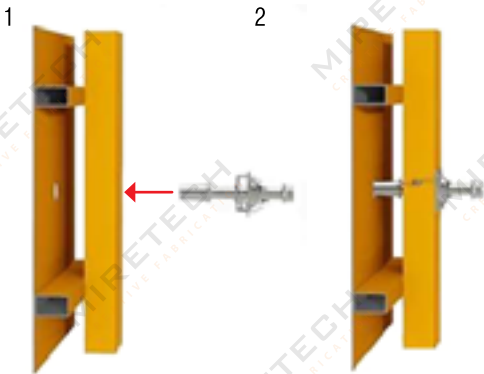

Tie Setting

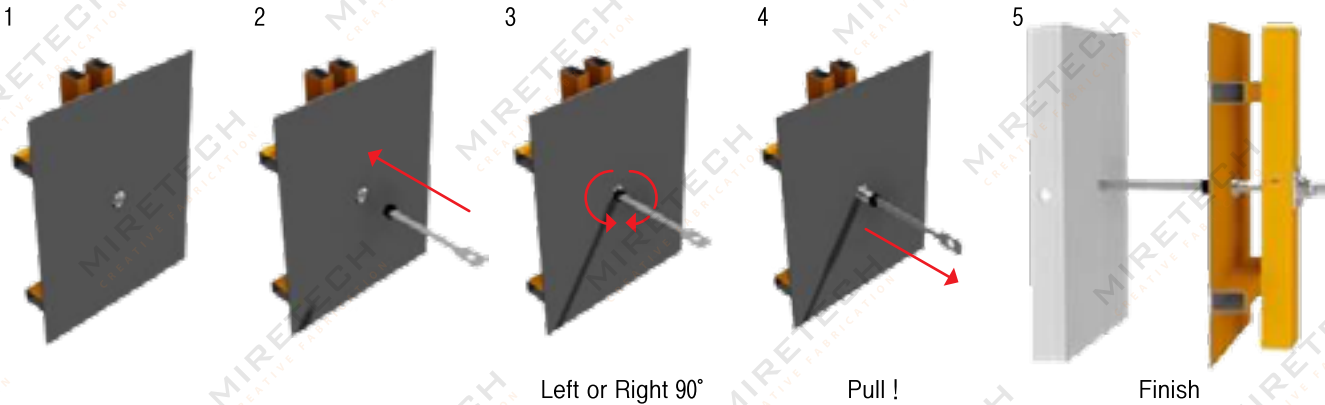

Unit Dismantling

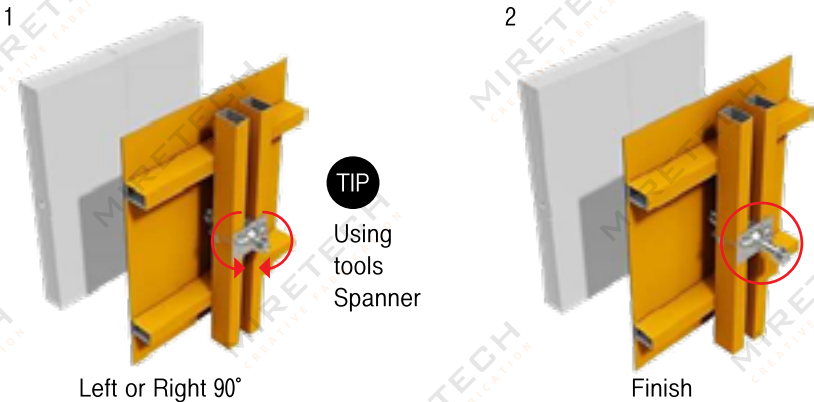

Inno Form Tie System

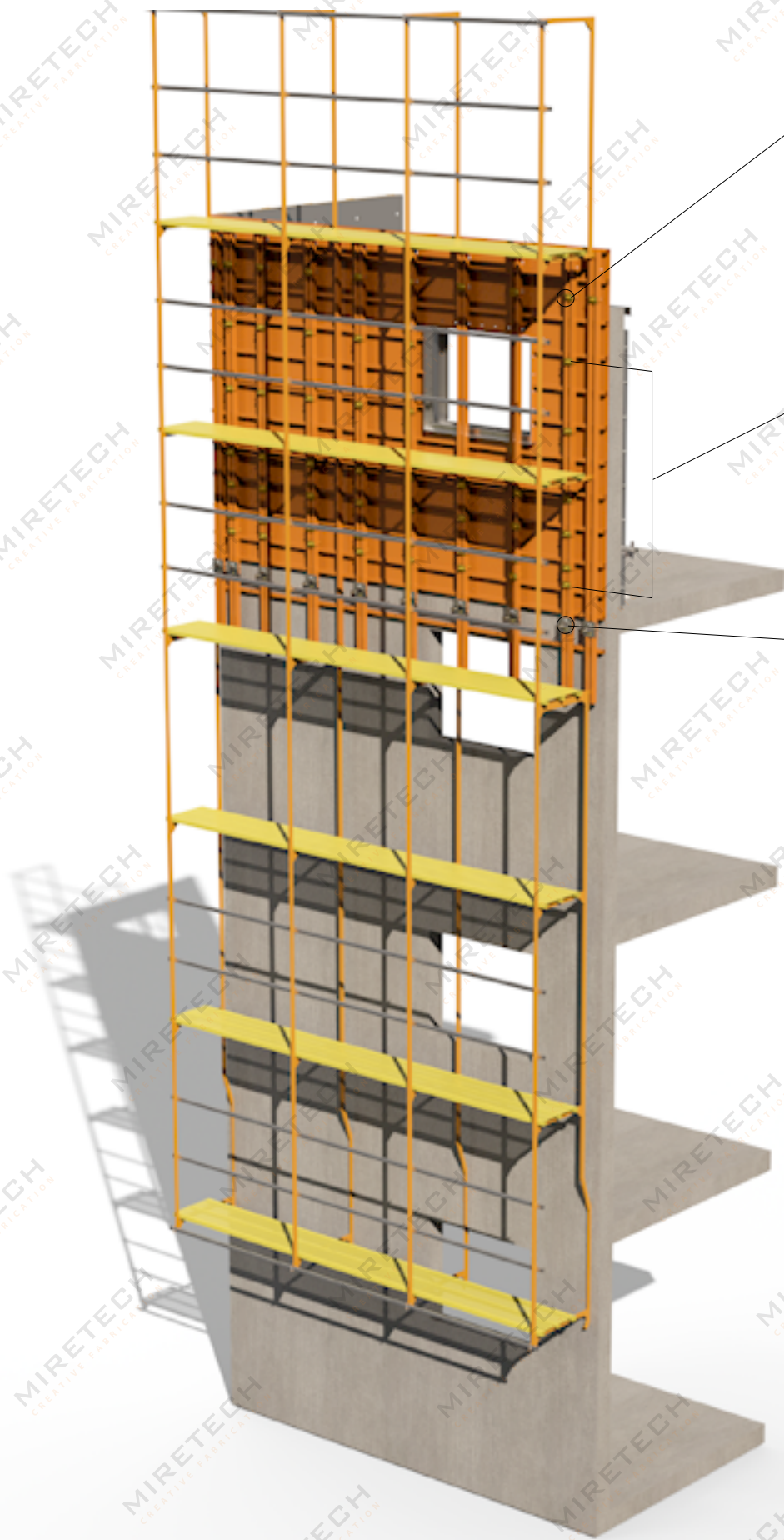

Embedded Anchor [Set]

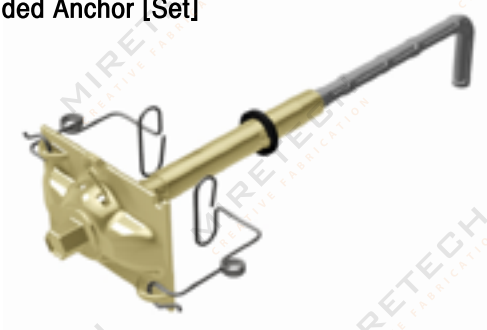

Inno Form Tie [Set]



Gang Form Fixing Anchor [Set]



Inno Form Tie System

Inno Unit [General]
Tensile Load / 4,000 kgf



Inno Unit [Pattern]
Tensile Load / 4,000 kgf

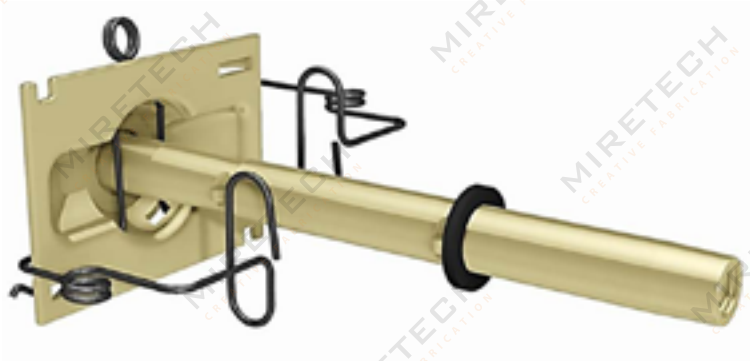

Order Manufacturing/Packaging

AL-Sepa Tie
Tensile Load / 3,000 kgf
Diameter / 12mm



Euro-Sepa Tie
Tensile Load / 3,000 kgf
Diameter / 12mm



Anchor Fixable Bolt
Tensile Load / 4,300 kgf
Diameter / 12mm



Order Manufacturing/Packaging

Inno Form Tie System

How To Use?

Unit Setting

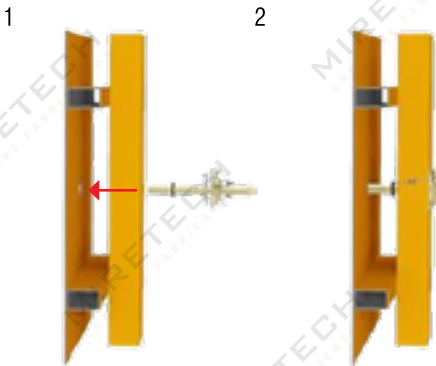

Tie Setting

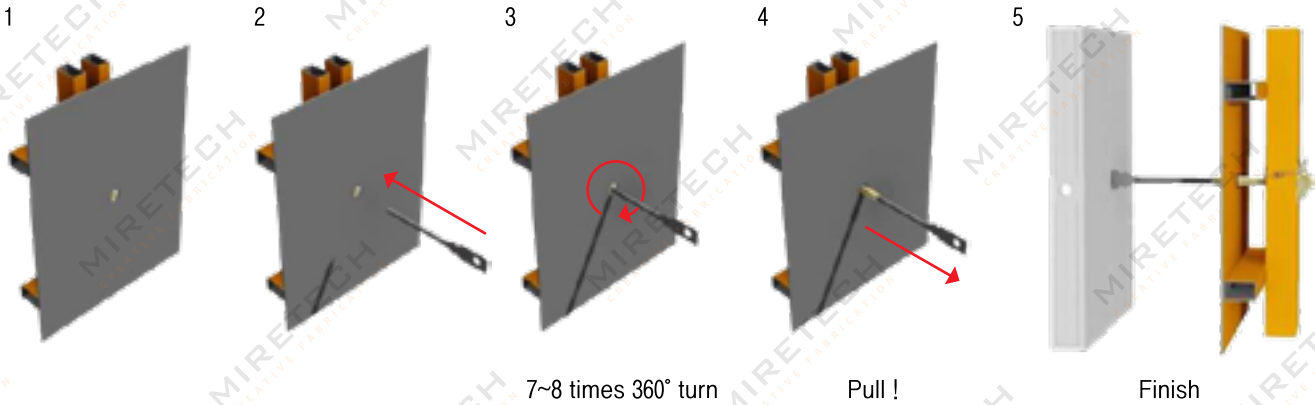

Unit Dismantling

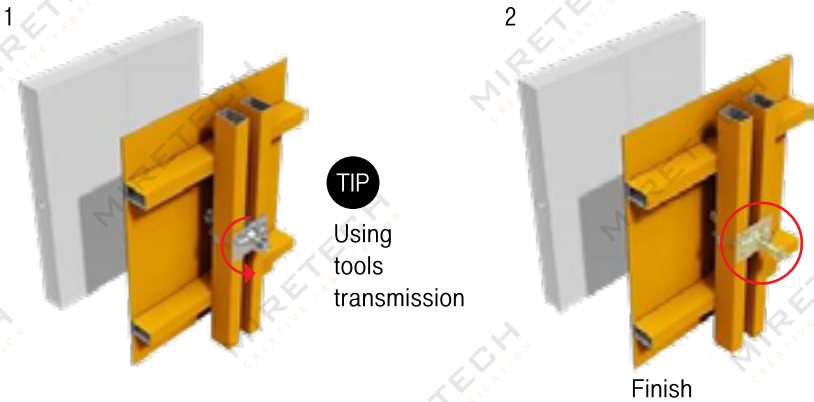

Easy Form Tie System

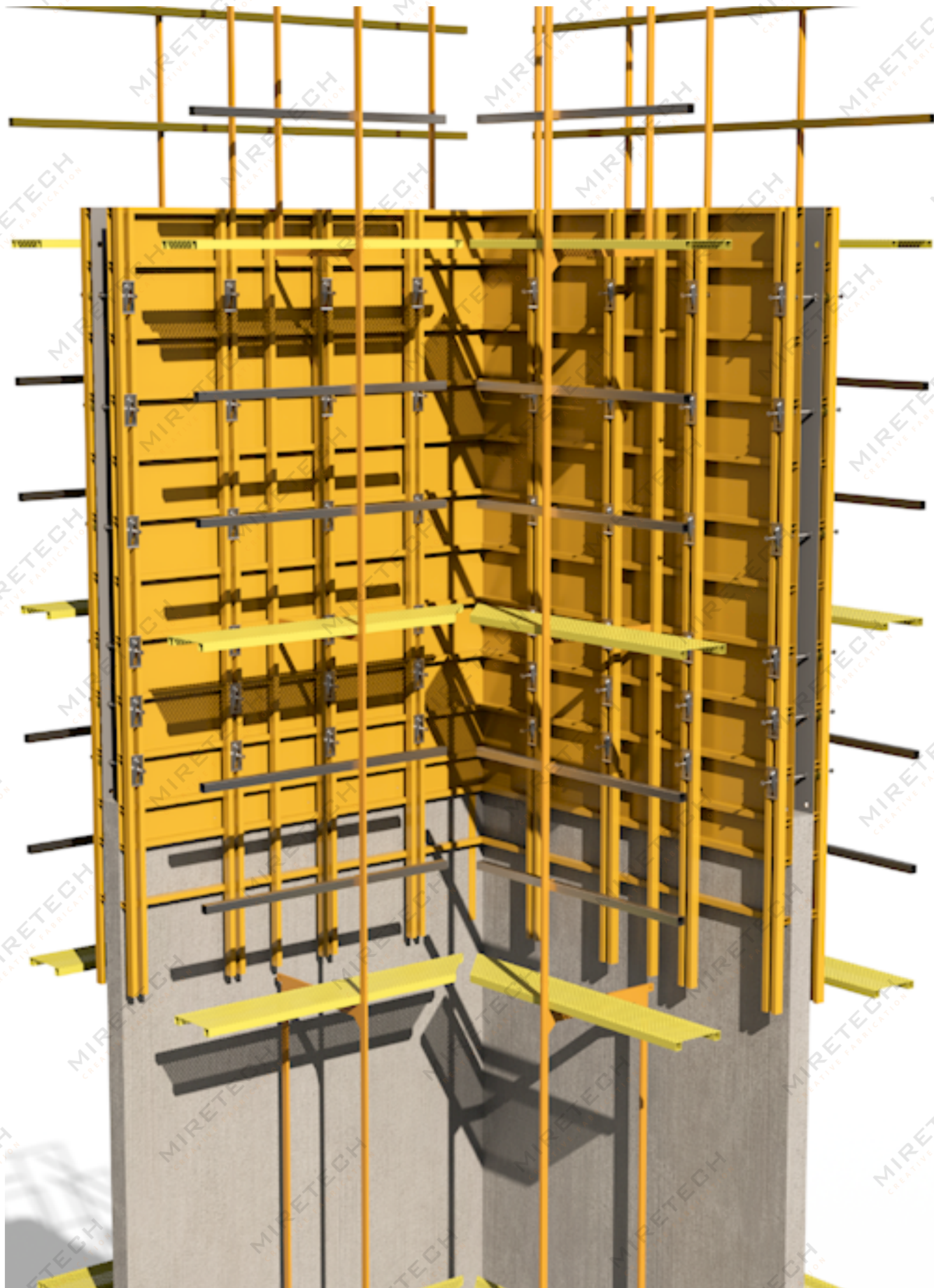

Form Tie System is suitable for structures where internal and external form work such as Gang Form is applied.

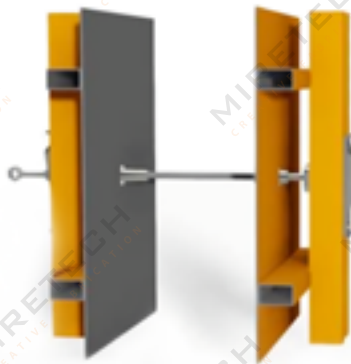

Assembly drawing

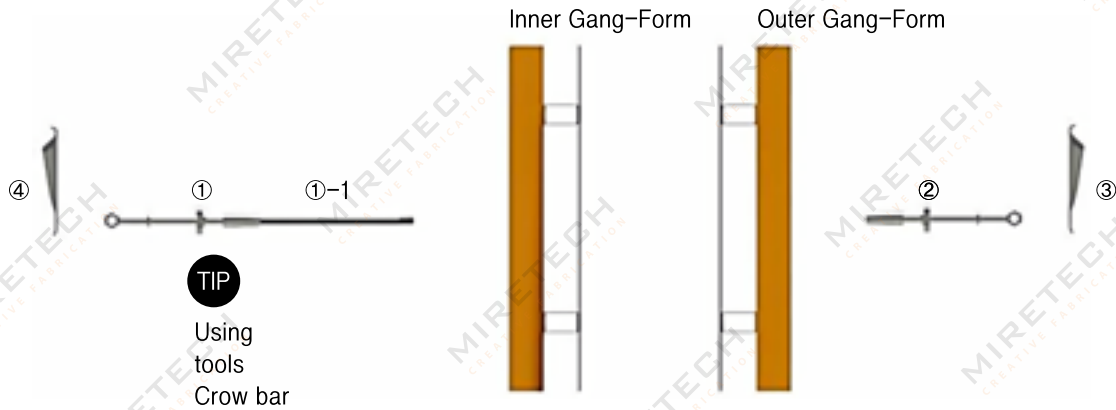

Easy Form Tie System

Easy Unit
Tensile Load / 4,000 kgf



Mire-Washer

2pieces
1Unit



Sepa Bolt [1/2"]
Tensile Load / 4,500 kgf
Diameter / 12mm



☑Order Manufacturing/Packaging

Dywidag Form Tie System

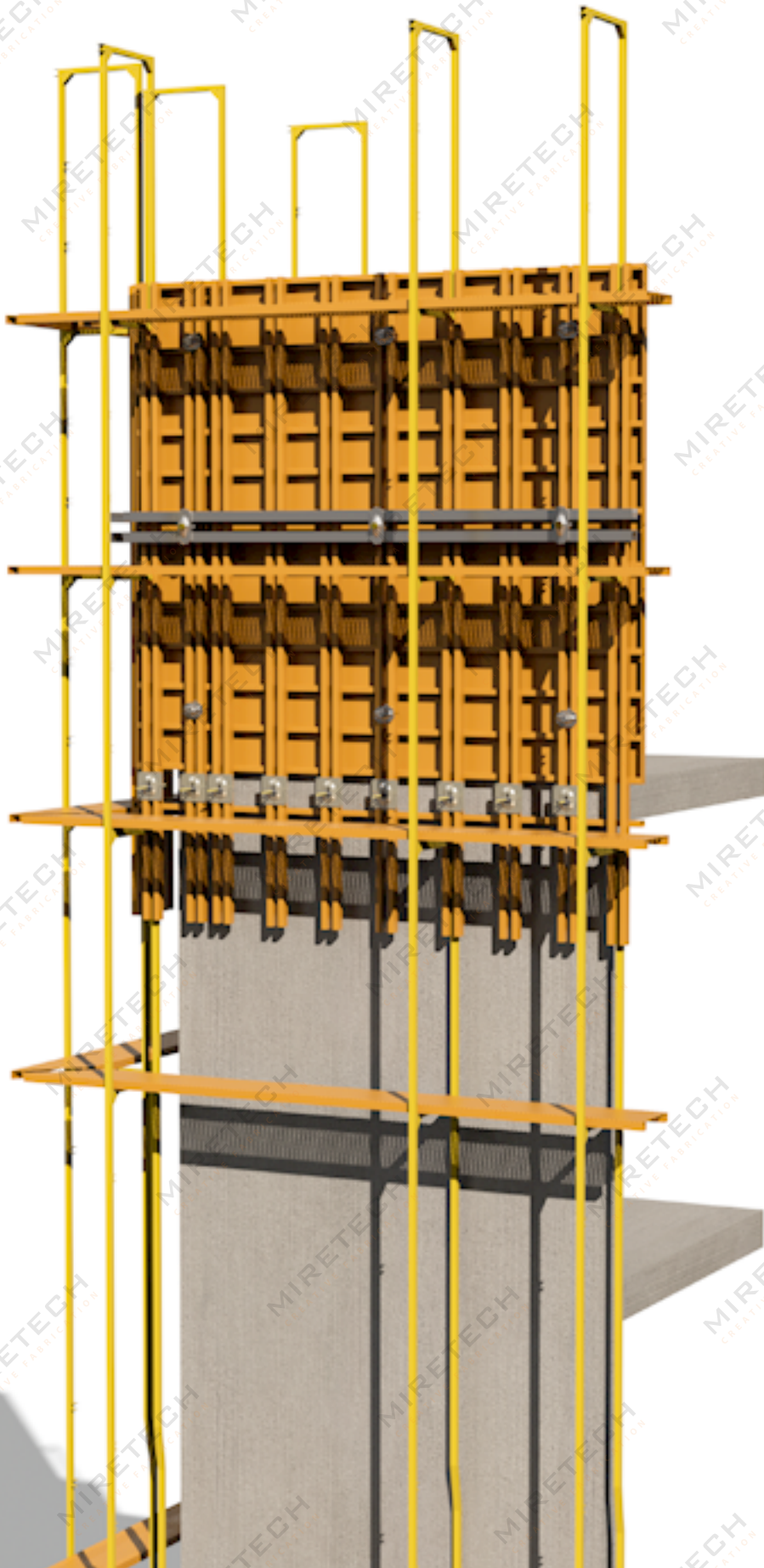

When applying Heavy Wall
Reduce Tie quantity
Reduce construction time
Enhance formwork strength
Improve construction quality

[A comparison of Form Tie quantity
in case in which Gang Form is applied in the same area]

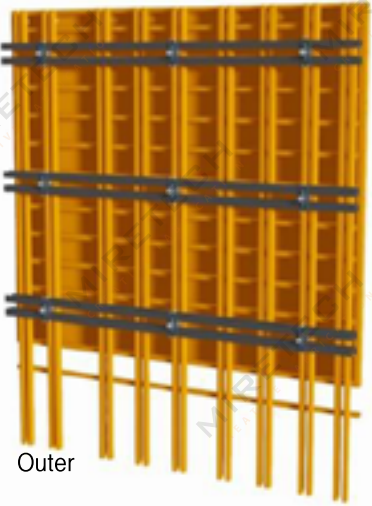

Outer

▲Dywidag Form Tie + Waller Plate
construction with 9 Form Ties



▲General Form Tie System
construction with 42 Form Ties



Inner

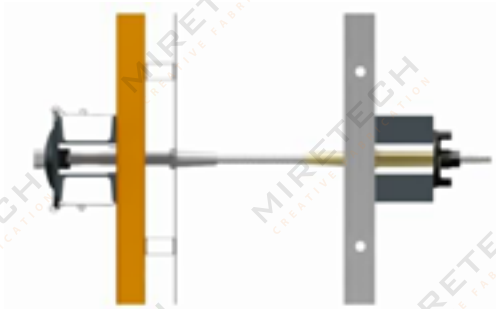

Outer Gang-Form Inner AL-Form

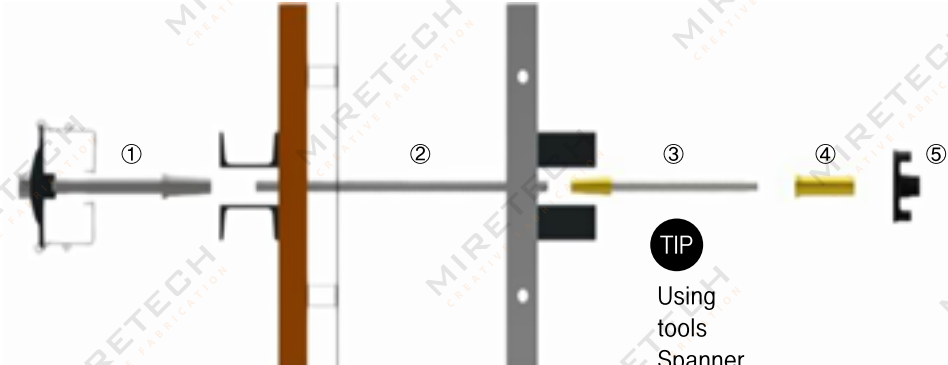

Dywidag Form Tie System

Dywidag Unit
Tensile Load / 14,700kgf



Dywidag Cone Bolt [Assembly]



🚚 Order Manufacturing/Packaging

Pipe Flange



Flange Nut
Size 17mm



Dywidag Cone Bolt
Tensile Load / 14,700kgf
Diameter / 17mm



Dywidag Bolt
Tensile Load / 14,700kgf
Diameter / 17mm



🚚 Order Manufacturing/Packaging

Gang- Forming Part



Anchor

Deformed Anchor Bolt
Pull out Load / 39,5 KN
Diameter / 12mm



Anchor Bolt
Pull out Load / 13,2 KN
Diameter / 12mm



Anchor Fixing Cap



Anchor Fixing Cap [Assembly]

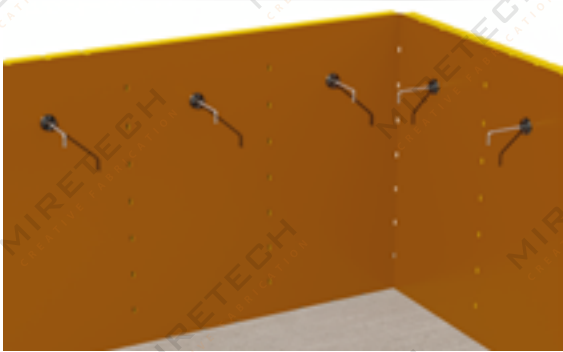
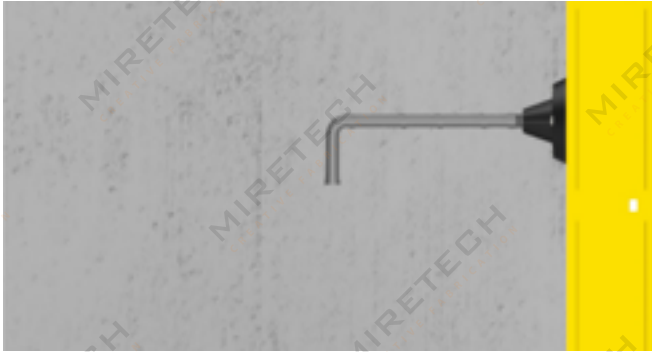

Slab Anchor



Order Manufacturing/Packaging

Setting

Gang-Form Fixing Washer



Gang-Form Joint Pin

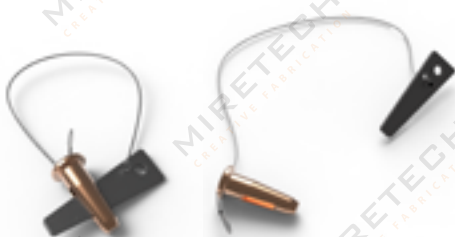

Wire Turnbuckle

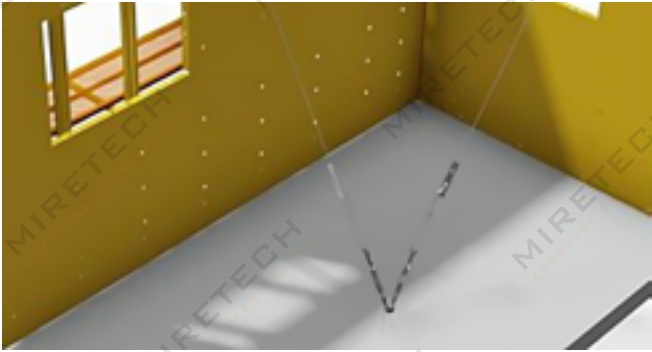

Order Manufacturing/Packaging

The image shows a construction site at sunset. A large tower crane is silhouetted against the bright orange and yellow sky. The crane's jib extends across the upper half of the frame. Below the crane, the skeletal frame of a building is visible, with several vertical columns and horizontal beams. The sun is low on the horizon, creating a strong backlight effect that silhouettes the structures and casts a warm glow. The overall scene is industrial and captures a moment of late-day construction activity.

Aluminium Form & AL-Forming Part

MICO Panel

MICO W (For Sale)
W600/450/400/300/200×H2400
Siderail 63.5mm, Skin 4mm W600×2400. ±30kg



Vertical reinforcement against the highest pressure

Wide tube Stiffener (80×60×59H) "Double Horn!" Double Horn Offers easy vertical and horizontal alignment and strength.



Wide tube Stiffener "Perfect Grip!" Increase the labor efficiency enabling safe and easy transfer of the panels



Tube Stiffener - STD (44×28×50H)



Corner Gusset

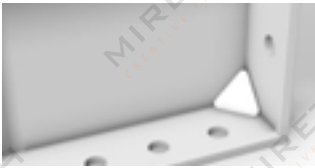

MICO All Hole pitch Same condition as Euro-form

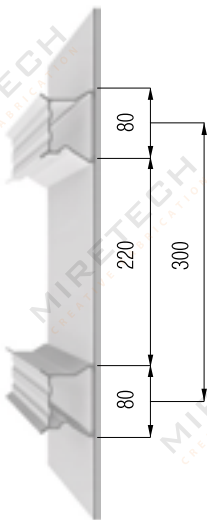

80×60×50H

80×60×59H



44×28×50H

Tube Stiffener architecture does not allow concrete to infiltrate into the stiffener.

Two convex on stiffener provide additional strength and dent resistance

Extruded Stiffener are serrated to prevent slipping and aid in handling. "Perfect Grip!"

Fully enclose tube design reduces noise.

MICO COLUMN

Sample Composed by
600×2400, 400×2400, (100+100)×2400

MICO D (For Sale) : W600/450/400/300/200×H1200
Siderail 63.5mm, Skin 4mm
W600×1200 standard ±14.5kg



ALUFORMS U.S. Panel

W900/600/450/400/300×H2400.
Siderail 54mm, Skin 3.2mm (rolling sheet) W900×2400. ± 38,5kg

Face sheet : 3.2T
Inset face sheet around full perimeter of panel
Full perimeter welded around outside rails



• Siderail & Sheet



top view



• Auto Pin
Auto pin provide easy & rapid
Installation for your job site



• Bushing
Bushings are proven to
protect your siderails & can
be reused numerous times
with the guarantee of long life



• Corner Gusset

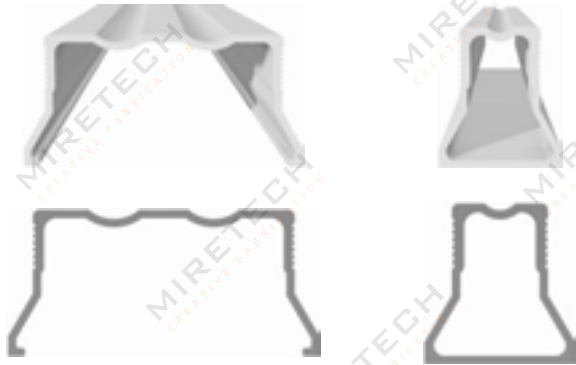

HAT type wide Stiffener supports the face sheet ,against deflection force resulting flat and glassy finished concrete surface.

Tube Stiffener architecture does not allow concrete to infiltrate into the stiffener.

Two convex on stiffener provide additional strength and dent resistance

ALUFORMS US Deck Panel
Auto Pin or Form Clip

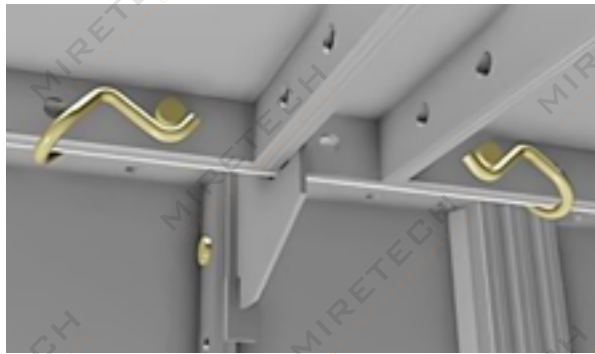

ALUFORMS US Panel Wall
Example image Composed by
900×2400 4ea (Interlocked by Auto Pin)



AL-Forming Part

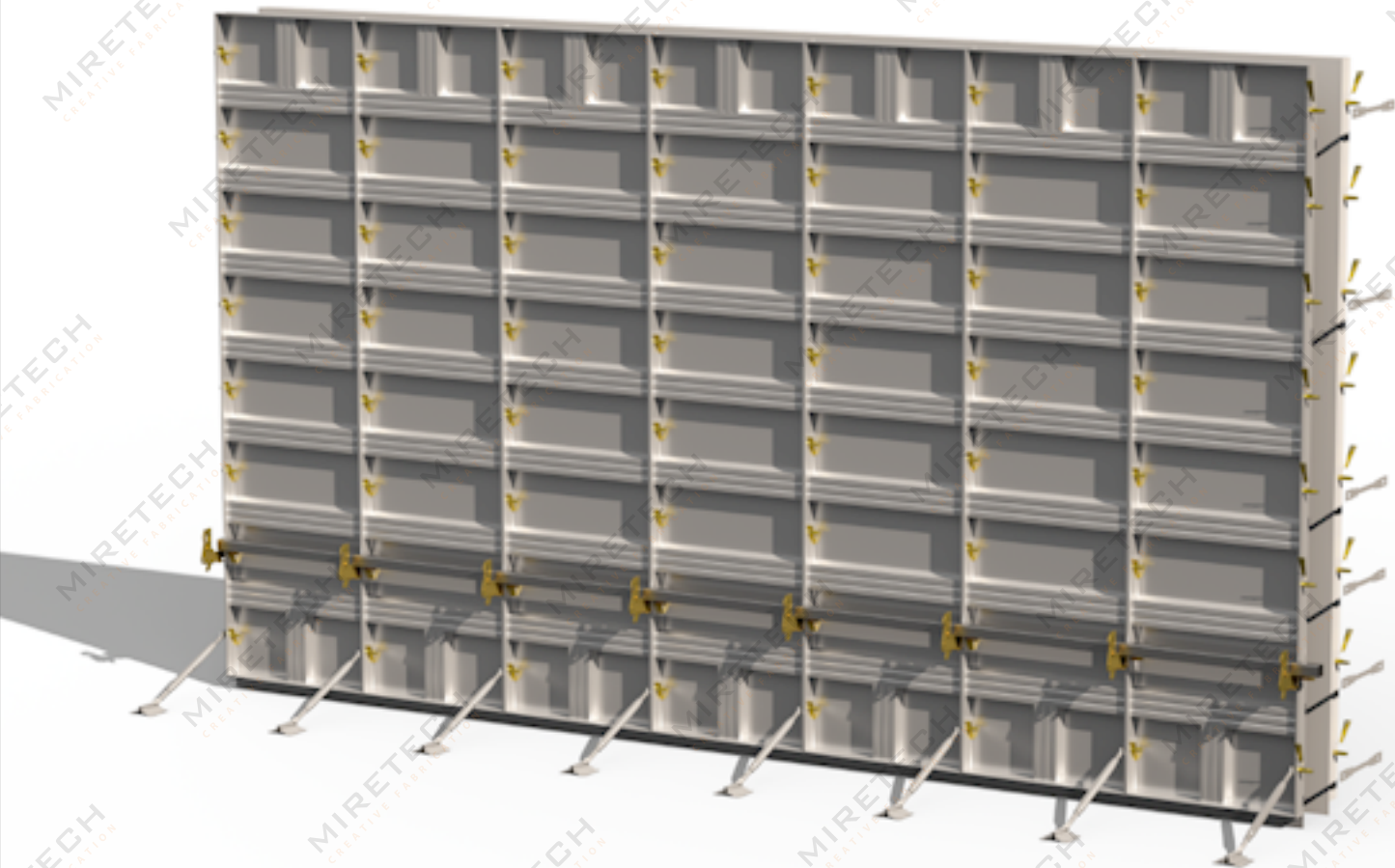

Tie [Embedded Type]

AL-Flat Tie [33]
Tensile Load / 3,000 kgf
Thickness / 1.9t



AL-Flat Tie [37]
Tensile Load / 3,000 kgf
Thickness / 1.9t



Round End Tie [Nominal Tie / Full Tie]
Tensile Load / 3,620kgf / 8,000lbs
Size 6", 8", 10", 12"
Thickness / 1.9t



☑ Order Manufacturing/Packaging

Tie [Embedded Type]

Break Back Tie [AL]
Tensile Load / 3,000 kgf
Thickness / 1.9t

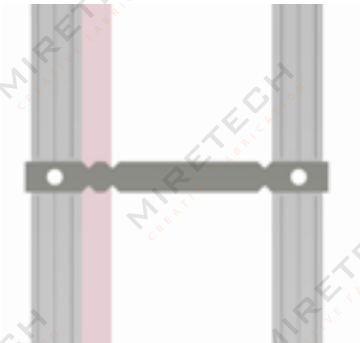

Rod Tie
Tensile Load / 2,800 kgf
Diameter / 12mm

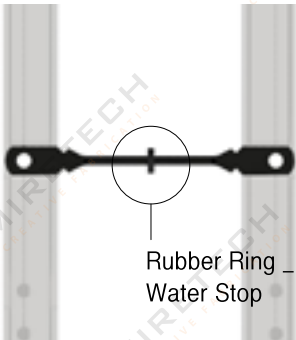

Z- Tie [AL]
Tensile Load / 3,000 kgf
Thickness / 1.9t



Order Manufacturing/Packaging

Tie [Reusable Type]

Reusable Tie [3Hole]
Tensile Load / 3,800kgf
Thickness / 2.8t



Reusable Tie [2Hole]
Tensile Load / 3,800kgf
Thickness / 2.8t



Tie Sleeve

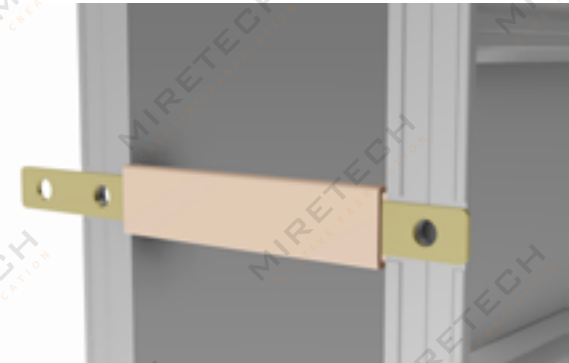
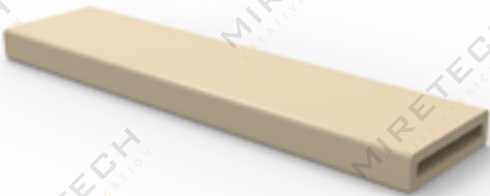

Order Manufacturing/Packaging

Tie [Reusable Type]

Re-cone tie
Over 300 wall thickness
Situation difficult to use reusable tie

Re-Cone Tie (Reusable Type)
Tensile Load / 3,800kgf

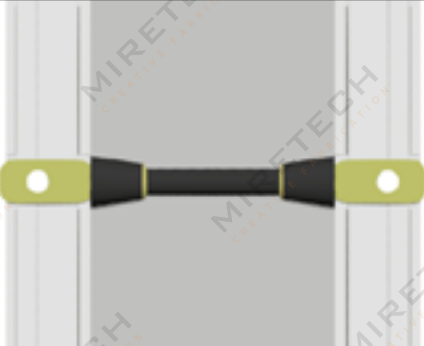
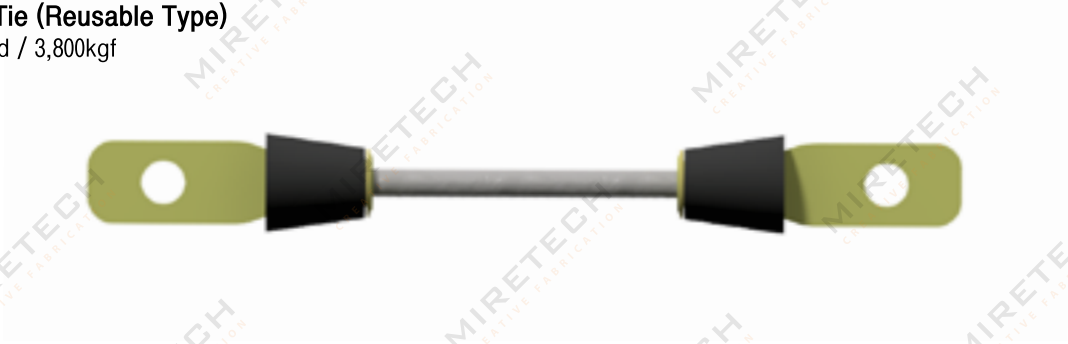

Re-Cone
Size 1/2"



PVC Pipe
Size 18mm

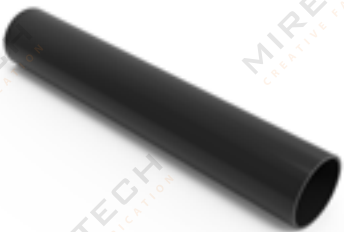

Sepa Bolt
Tensile Load 1/2" 4500kgf
Diameter / 12mm



Order Manufacturing/Packaging

Pin

Stub Pin
Diameter / 16mm



Standard Pin
Diameter / 17.2mm



AL-Filler Pin
Diameter / 16mm



Beam Pin
Diameter / 16mm

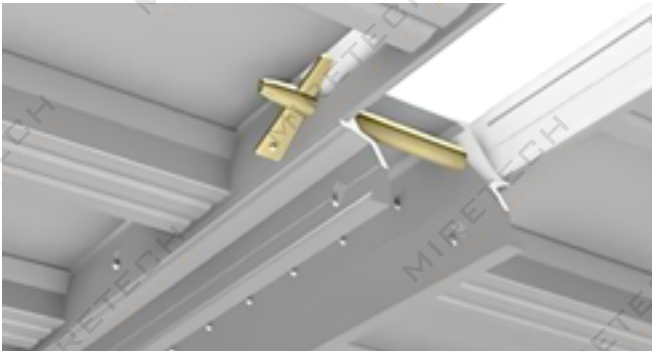

Order Manufacturing/Packaging

Wedge

AL-Wedge
Thickness / 2.5t, 2.8t

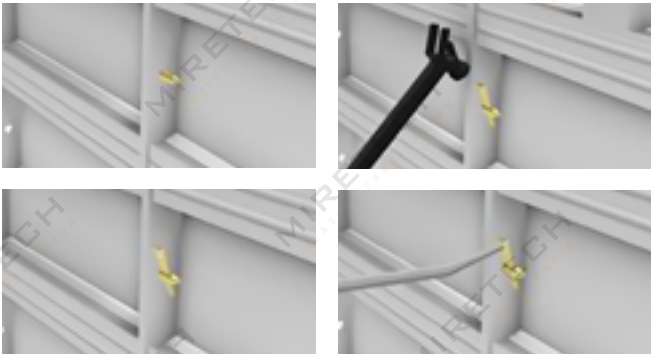

Straight Wedge
Thickness / 3.0t



Curved Wedge
Thickness / 3.0t



Euro Form Wedge
Thickness / 4.3t



Order Manufacturing/Packaging

Clip

Easy construction
Pins and wedges loss prevention
Noise prevention

Auto Pin
Slide type



Form Clip [Deck Panel]

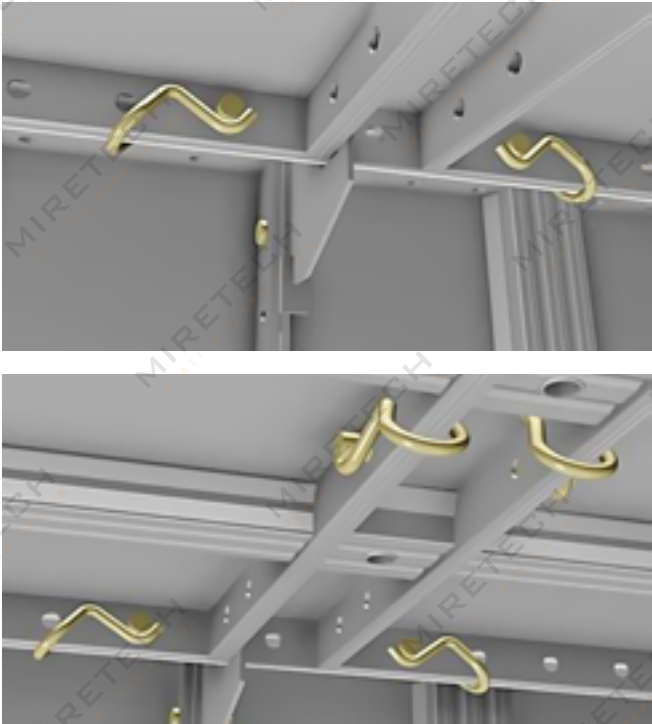

Order Manufacturing/Packaging

Waler Bracket

AL-Bracket [Wedge type]
Thickness / 4.5t



AL-Bracket [Bolt Type]



Order Manufacturing/Packaging

Turnbuckle Bracket

AL-Turnbuckle Bracket

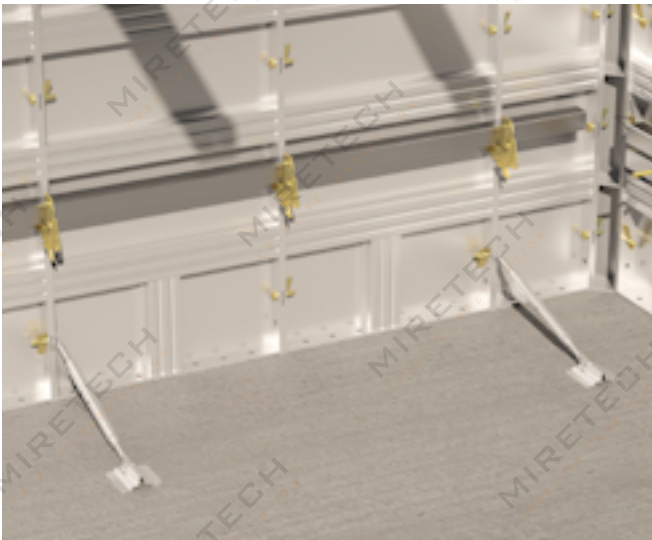

Conner Turnbuckle Bracket



Wall Brace



Order Manufacturing/Packaging

TOOL



Tie Breaker Bar



Form Puller



📄 Order Manufacturing/Packaging

TOOL

Tie Puller



Ejector Bar



☑Order Manufacturing/Packaging

Stripper [Alignment Tool]



Form Scrapper



☑Order Manufacturing/Packaging

Kicker Anchor System



Kicker Anchor System

Reduce materials and labor cost
Reduce construction time

Kicker Anchor [Assembly]



Kicker Nut



Kicker Bolt

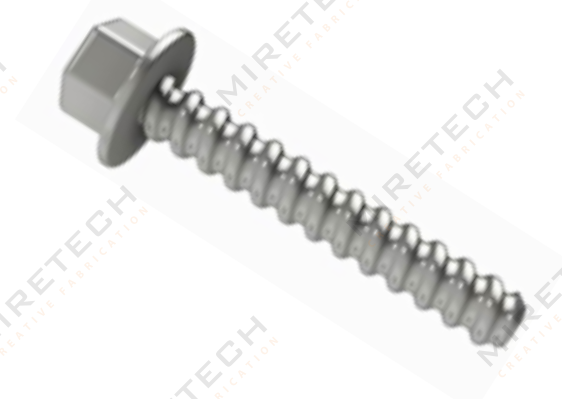

🛒 Order Manufacturing/Packaging

Kicker Anchor System

How To Use?

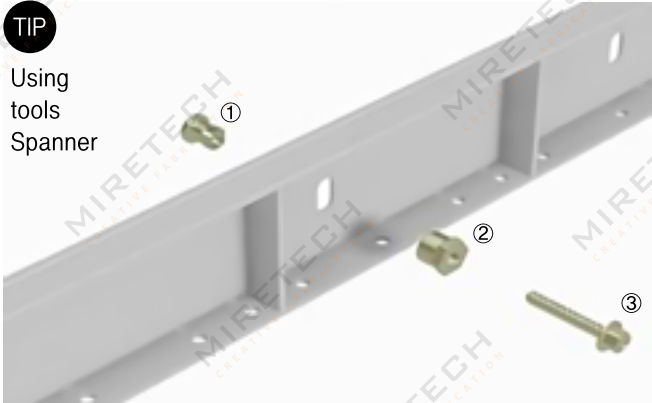

Compare Kicker Anchor Form with traditional method

Kicker Anchor Form construction method
Reusable Anchor bolt

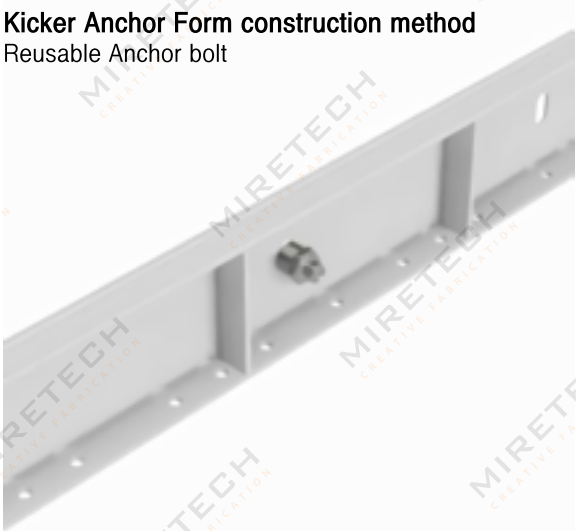

Traditional construction method
Embedded Anchor bolt

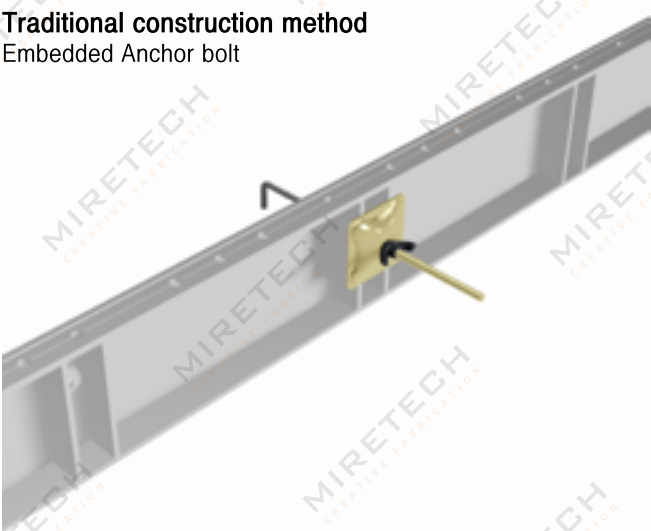

Order Manufacturing/Packaging

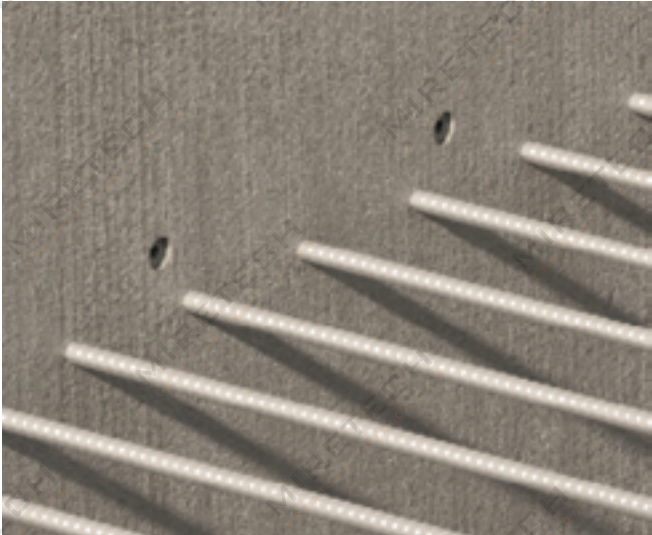
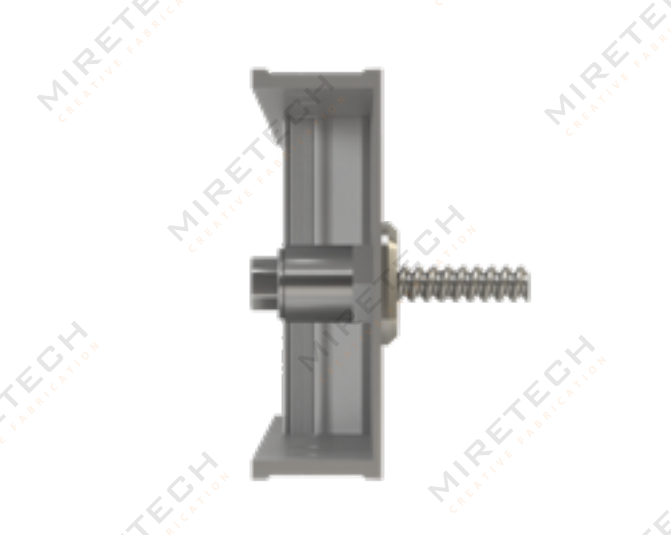
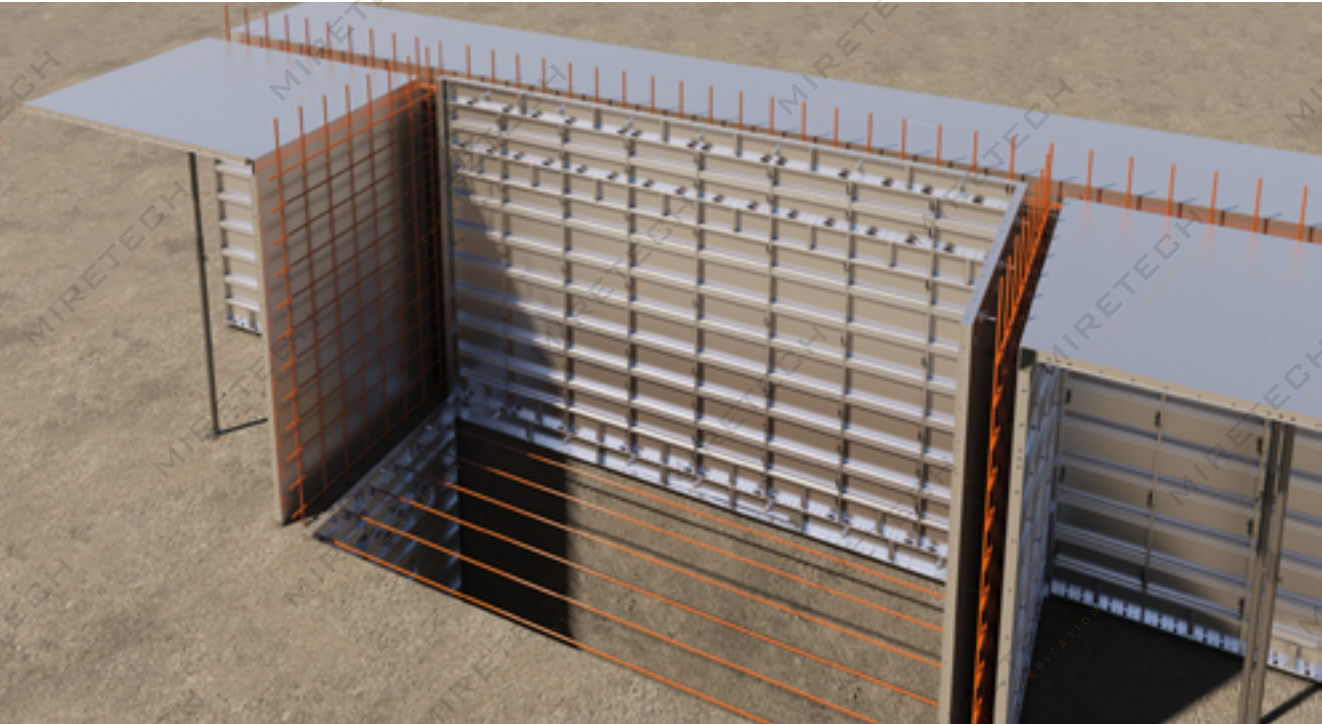

Order Manufacturing/Packaging

Column



Dywidag Washer
Size 130*90*5T

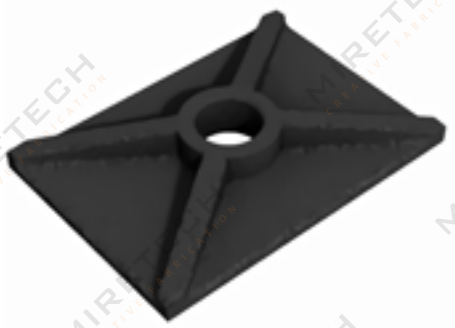

Waler Band
Customized



Dywidag Bolt
Tensile Load / 14,700kgf
Diameter / 17mm



Dywidag Nut
Size 17mm



Flange Nut
Size 17mm



☑ Order Manufacturing/Packaging

Scaffold Bracket

Wall Bracket

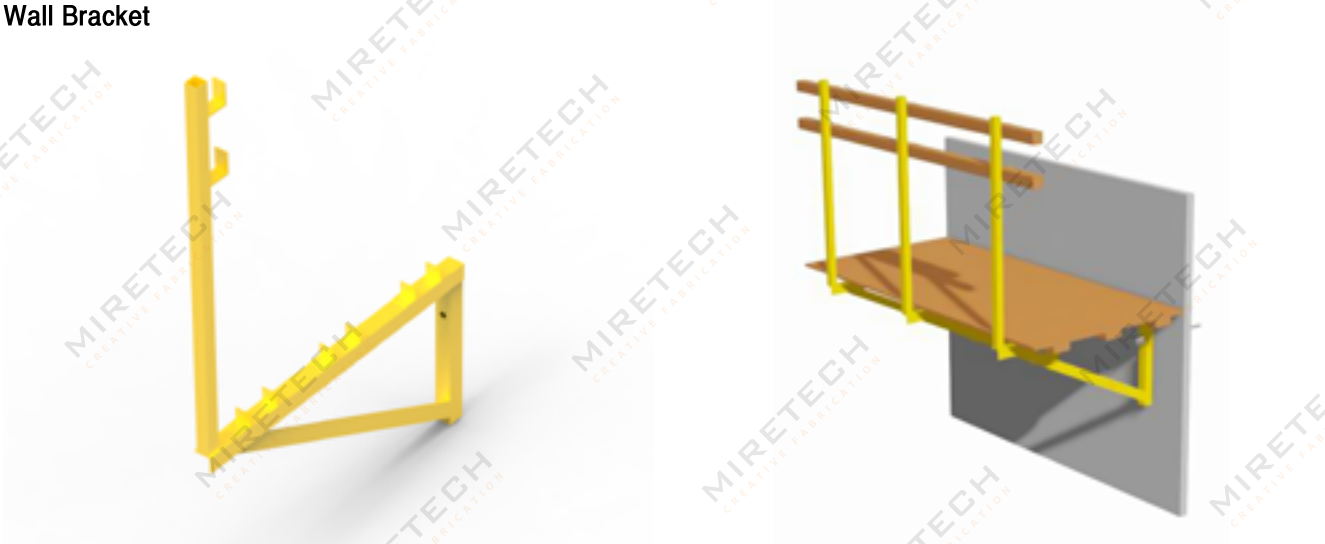

Slab Bracket



Bracket Fixing Bolt [Assembly]



Order Manufacturing/Packaging

MISC

Form Spacer [General Type]

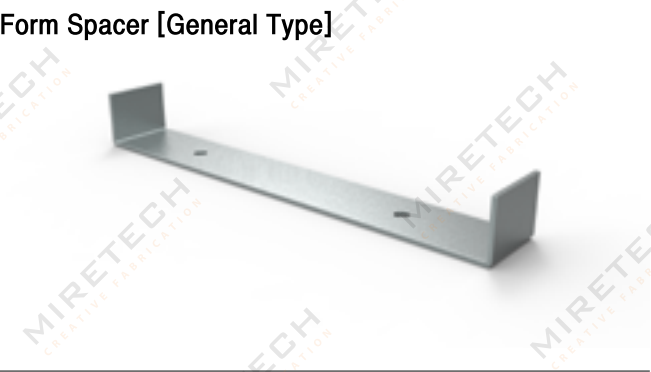

Form Spacer [L-Type]

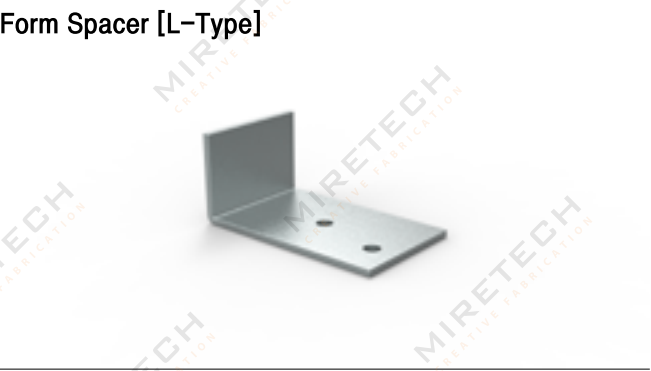

Extension Bracket

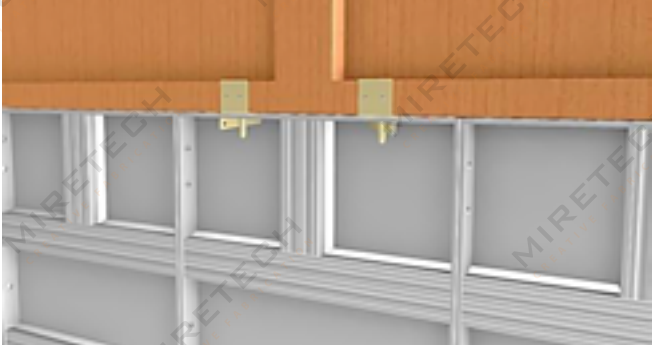

Order Manufacturing/Packaging

A large-scale construction site at sunset. The scene is dominated by the silhouettes of a massive crane and a building under construction. The crane's long jib extends across the upper half of the frame, supported by cables. The building's skeletal frame, including columns and beams, is visible against the bright, orange-hued sky. The sun is low on the horizon, creating a strong backlight effect and casting long shadows. The overall atmosphere is industrial and dramatic.

Euro- Forming Part

Euro-Forming Part

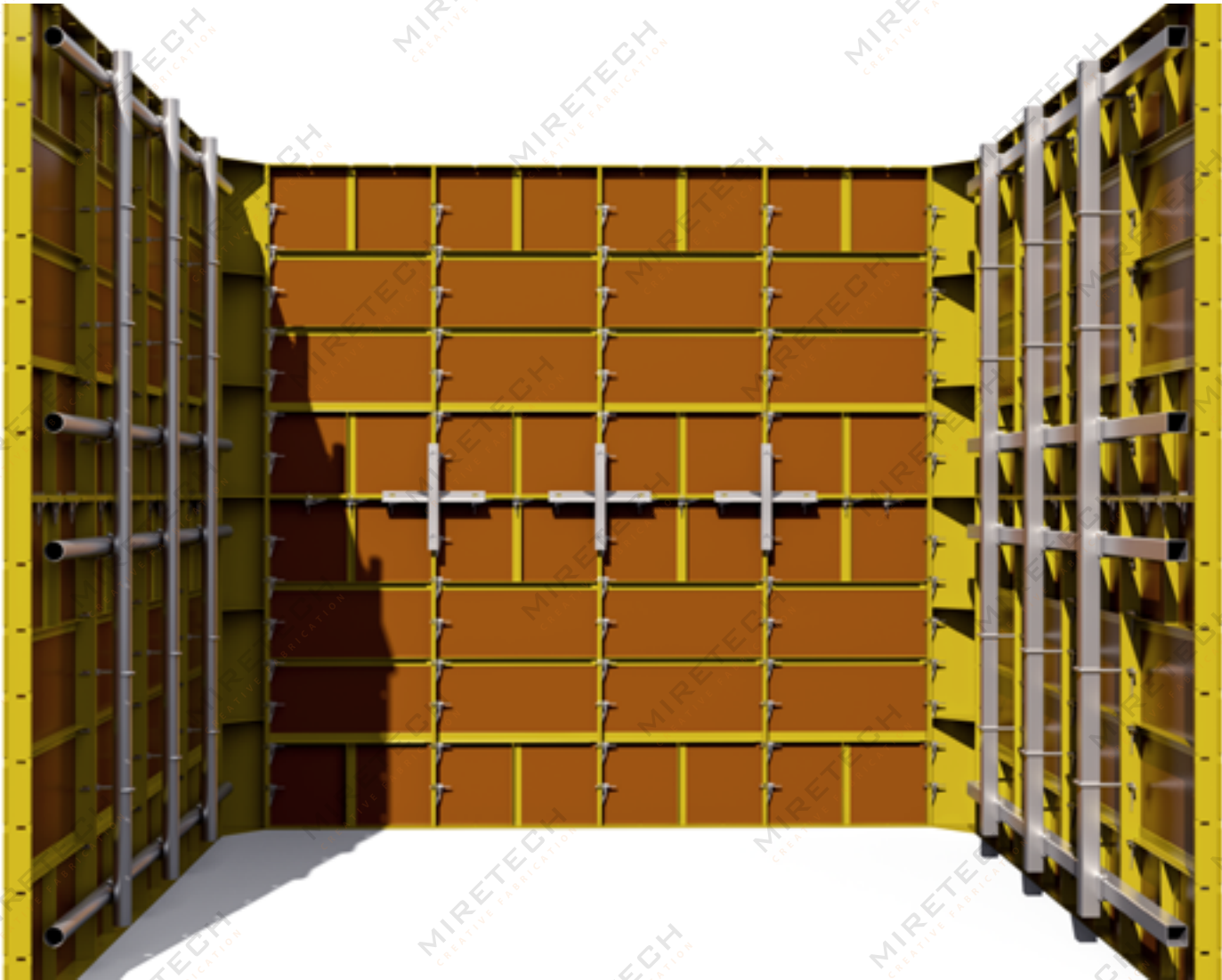

Tie

News

Thickness 2.8T
Tensile Load / 2,800kgf

Euro-Flat Tie
Thickness / 2.8t

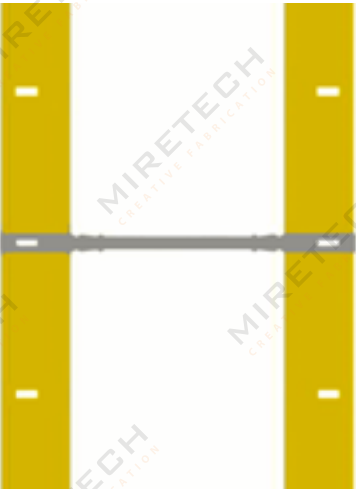

Euro-Double Tie
Thickness / 2.8t

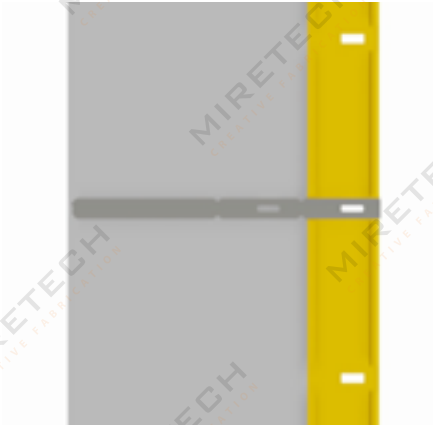
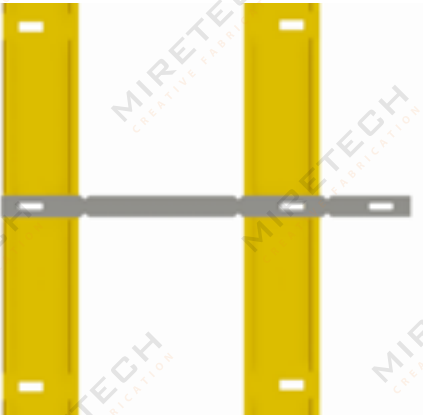

Order Manufacturing/Packaging/ Packaged

Tie

Z- Tie [Euro]
Thickness / 2.8t



Pin Bolt [Euro]
Diameter / 12mm



Pin Bolt [Assembly]



Order Manufacturing/Packaging

Wedge

Euro-Wedge
Thickness / 4.3t



Euro-Filler Pin
Thickness / 4.3t



Order Manufacturing/Packaging

News

Thickness 4.3T

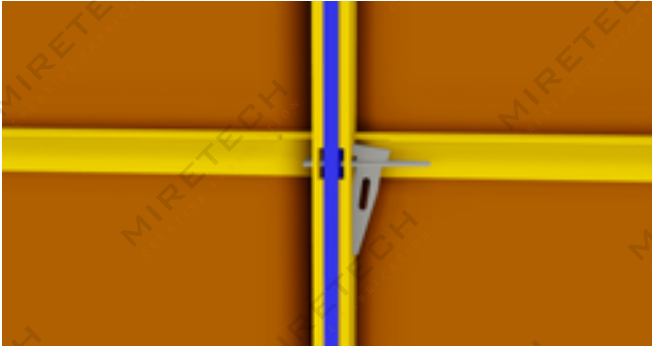

Hook

Round Pipe Hook [Large]



Round Pipe Hook [Small]



Square Pipe Hook [Large]



Square Pipe Hook [Small]

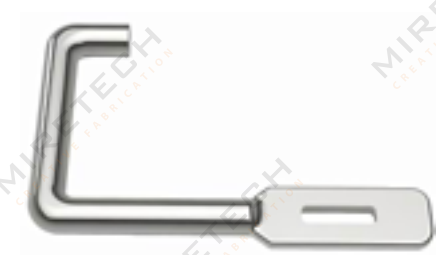

Order Manufacturing/Packaging

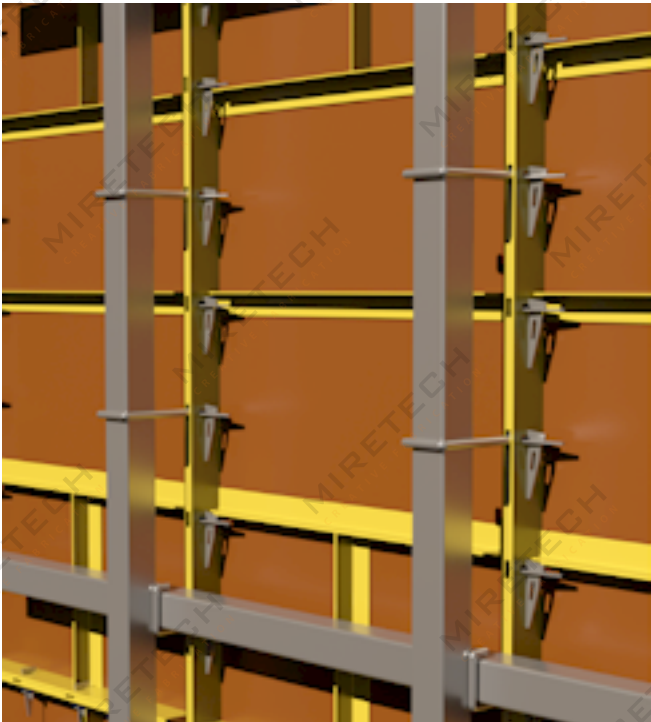

Joint Bar [Cross Type]

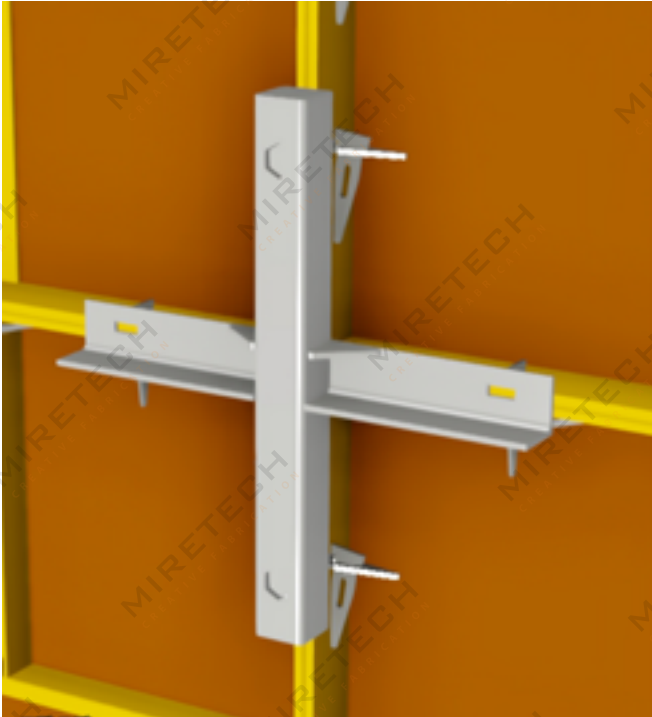

Order Manufacturing/Packaging

A large-scale construction project is captured at sunset. The scene is dominated by the dark silhouettes of a building's steel framework and several tall tower cranes against a bright, orange-hued sky. The sun is low on the horizon, creating a strong backlight effect that highlights the intricate details of the construction. The overall atmosphere is one of industrial activity and the end of a day's work.

Wood- Forming Part

Wood-Forming Part

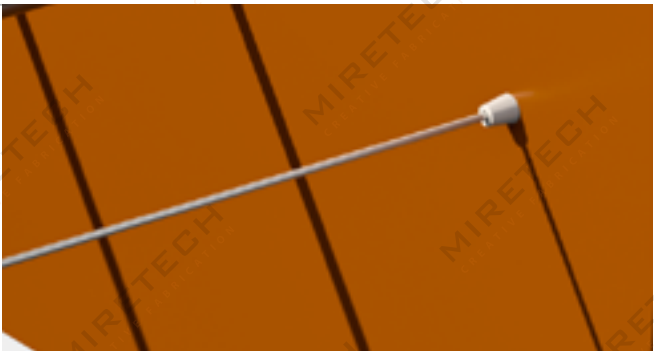
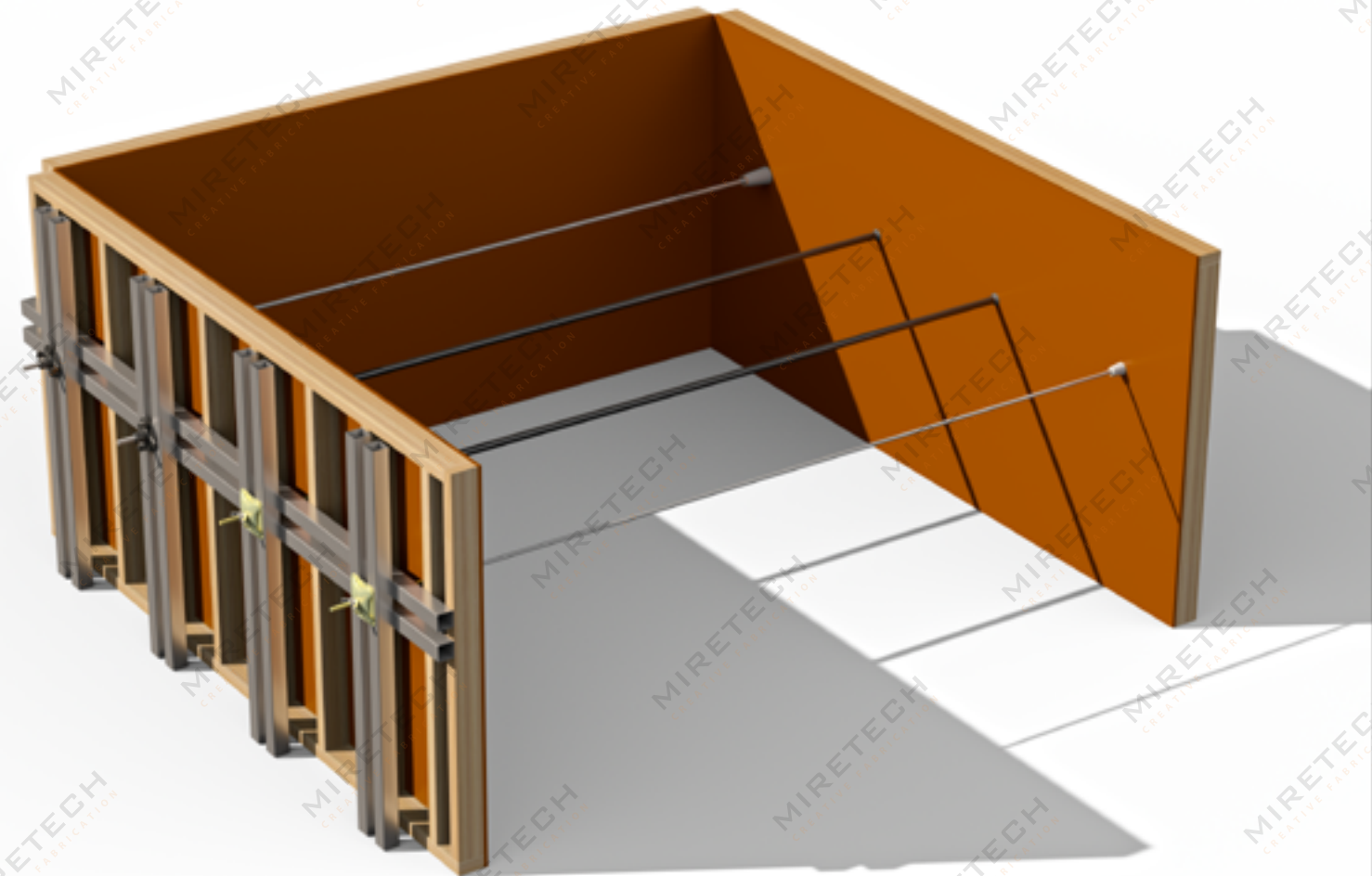

Dywidag Form Tie System [Embedded Type]

Component _one dywidag bolt, two dywidag cone, two dywidag nut and washer(or two flange nut)

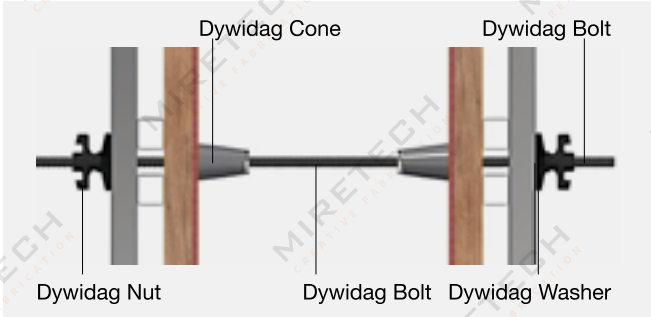

Dywidag Bolt
Tensile Load / 14,700kgf
Size 17mm



Flange Nut
Size 17mm

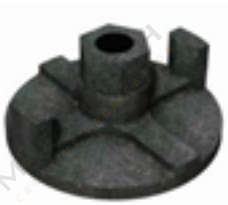

Dywidag Nut
Size 17mm



Dywidag Washer
Size 17mm



Dywidag Cone
Size 17mm



[Reusable Type]

Component _one dywidag bolt, two dywidag nut and washer(or two flange nut, one PVC Pipe, two PVC Cone)

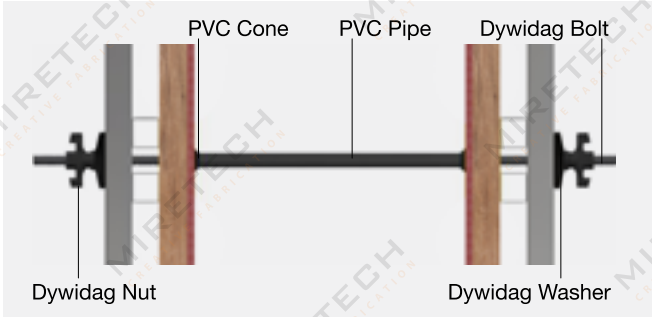

Dywidag Bolt
Tensile Load / 14,700kgf
Size 17mm



Flange Nut
Size 17mm



Dywidag Nut
Size 17mm



Dywidag Washer
Size 17mm



PVC Pipe
Size 18mm, 22mm



PVC Cone
Size 18mm, 22mm



Form Tie Bolt System
[Embedded Type]

Component _one sepa bolt, two form tie bolts, tow D cons, two square washers, two wind nuts

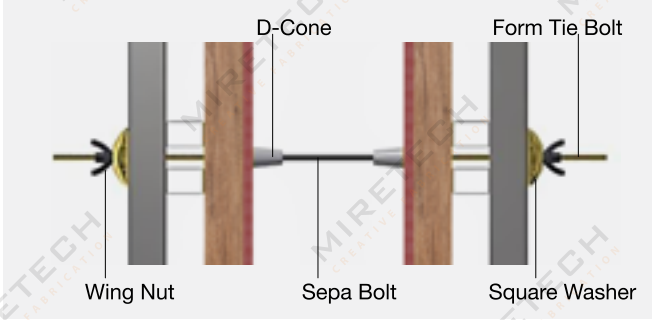

Sepa Bolt
Tensile Load / 12mm 4,500kgf, 16mm 7,000kgf



Form Tie Bolt
Tensile Load / 12mm 3,600kgf, 16mm 7,000kgf



[Reusable Type]

Component _one tie rod, two square washers, two wing nuts, one PVC pipe, tow PVC cones

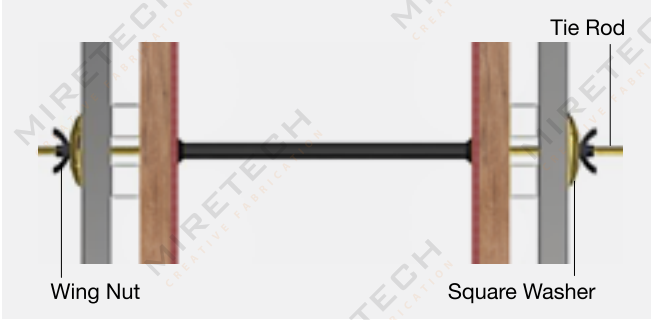

Tie Rod
Tensile Load / 12mm 4,500kgf, 16mm 7,000kgf



Square Washer
Size 12mm, 16mm

Wing Nut
Size 12mm, 16mm



Square Washer
Size 12mm, 16mm



Wing Nut
Size 12mm, 16mm



PVC Pipe
Size 18mm, 22mm



PVC Cone
Size 18mm, 22mm



D Cone
Size 12*40mm, 16*60mm



Order Manufacturing/Packaging

Contact Us

MAIL. supporters@miretech21.com

MIRETECH
CREATIVE FABRICATION

Form Accessories Factory

Head Office_Suseo Hyundai Ventureville 923, 10, Bamgogae-Ro 1-Gil, Gangnam-Gu, Seoul, Republic Of Korea
TEL. +82.2.445.2636 FAX. +82.2.2226.3488

Form Accessories Factory_41, Geomdan-Ro 27-Gil, Buk-Gu, Daegu, Republic Of Korea
TEL. +82.53.380.3400 FAX. +82.53.383.2695

Formwork Factory

1138, Singi-Dong, Mungyeong-Si, Gyeongsangbuk-Do, Republic Of Korea
TEL. +82.54.550.7500 FAX. +82.54.550.7530

Innovative Formwork System
ALUFORMS

Aluforms Korea Co.Ltd
Suseo Hyundai Ventureville 518, 10, Bamgogae-Ro 1-Gil, Gangnam-Gu, Seoul, Republic Of Korea
TEL. +82.2.425.7257 FAX. +82.2.425.7258

Factory_749-10, Chogeum-ro, Geumwang-eup, Eumseong-gun, Chungcheongbuk-do

Branch

India / Mexico / Malaysia / Thailand

